



INSTRUCTIONS FOR ASSEMBLY OF MULTI VISTA BASE



Unwrap and remove all parts from each box. Keep the boxes and packing material until the cage is assembled. In case of return or exchange failure to return product in similar condition as received could result in limited reimbursement. Check to ensure you have all the following parts:

Cage Parts (see numbered diagram)

| | |
|--|-----------------------------|
| (1) BASE FRAME AND 4 CASTERS | (12) 2 TRAYS |
| (2,8) 2 FRONT PANELS (WITH DOORS) | (13,14) 4 GRATES |
| (3,9) 2 BACK PANELS | (15) FILL IN PANEL |
| (4,10) 4 SIDE PANELS (WITH NEST DOORS) | (16) 4 CUP HOLDERS AND CUPS |
| (5) LIGHT BOX FRONT PANEL (SHORT) | (17) 10 LATCHES |
| (6) LIGHT BOX BACK PANEL (SHORT) | 2 PERCHES |
| (7) 2 LIGHT BOX SIDE PANELS (SHORT) | BOTTLE OF TOUCH UP PAINT |
| (11) TOP PANEL | |

The following instructions are for assembly of the Multi Vista Base cage only. If you have purchased one or more expansion packages, please refer to instructions in the expansion package ONLY.

You will be building a cage with two modules, separated by a LIGHT BOX. You may optionally leave out the LIGHT BOX and mount the upper cage module directly on top of the lower module, resulting in a lower overall cage height. Leave out steps 5 through 7 for this configuration.

Cage Assembly (instruction numbers correspond with the attached numbered diagram):

1. Place the BASE upside down and insert the CASTERS into the legs (they can be installed using a rubber mallet on the metal stem, NOT on the rubber wheel).
2. Place the BASE upright and insert a FRONT PANEL over the pegs. It may lean out, this is normal for all panels as the cage is assembled. Panels are pulled together when you install the next layer.
3. Insert a BACK PANEL over the opposite pegs.
4. Insert both SIDE PANELS, ensuring the panels are fully seated - the tops of all four panels should be about even in height. Note that the pegs on the bottom of the side panels go through brackets on the bottom/back of the front and back panels, then into openings in the BASE. This method is used in some of the following steps as well.
5. Place the LIGHT BOX FRONT PANEL (horizontally hinged door) on top of the FRONT PANEL. The door should be latched closed, see step 17 for latch assembly instructions.
6. Place the LIGHT BOX BACK PANEL on top of the BACK PANEL.
7. Take one of the LIGHT BOX SIDE PANELS and draw the FRONT and REAR lower panels together by inserting each side panel pin through the LIGHT BOX FRONT PANEL bracket and then into the mating hole in the lower SIDE PANEL, while doing the same for the BACK LIGHT BOX PANEL. Repeat for the other LIGHT BOX SIDE PANEL.
8. Place the remaining FRONT PANEL on top of the LIGHT BOX FRONT PANEL.
9. Place the remaining BACK PANEL on top of the LIGHT BOX BACK PANEL.
10. Place the remaining two SIDE PANELS in place, pulling the LIGHT BOX front and back PANELS together as you install each SIDE PANEL.
11. Place the TOP PANEL in place by pulling the PANELS together at each corner and inserting the two pegs at each corner of the TOP PANEL into the two open square tubes.

12. Install a GRATE and TRAY into tracks through the lower opening in each FRONT PANEL. The tray can be in the upper track for use without a grate, if desired. Note that the track rails are sloped to more effectively direct debris into the tray.
13. Install a GRATE through the opening at the top of the LOWER FRONT PANEL. This divides the lower cage from the LIGHT BOX. This grate can be left out to increase the height of the lower cage, or to completely join the cage vertically.
14. Install a GRATE through the opening at the top of the LIGHT BOX. This grate divides the LIGHT BOX from the module above, and provides a place from which to hang a full spectrum light (light and mounting hardware not included). This grate can be left out to completely join the cage vertically.
15. If joining the cage completely vertically, use the FILL IN PANEL. It mounts to the back of the hinged door on the LIGHT BOX. When the LIGHT BOX DOOR is closed, the FILL IN PANEL covers the tray/grate opening in the upper cage module. If not joining the cage, this panel is not used.
16. Install CUPHOLDERS from inside the cage. The pegs insert into the tubes welded at the sides of the opening. When the food doors are closed the cupholders are locked in place.
17. To install each LATCH, first remove the knob by unthreading it. Ensure the spring is placed over the round end of latch. Insert the latch and spring into the lock sleeve so that the round end protrudes through the opposite end, and the angled surface faces in. Position the latch so that the threaded hole is visible through the front keyhole shaped opening and screw the knob through the lock sleeve into the threaded hole on the latch. Turn counter-clockwise to loosen and open the door. When securing the door, tighten clockwise all the way to the "lock" position.

Note that the latches for the LIGHT BOX DOOR should be installed with the angled surface facing out – the round ball screws in from the side opposite that shown in the illustration.

Also note that a "door within a door" has been added to the front panels since this diagram was drawn.

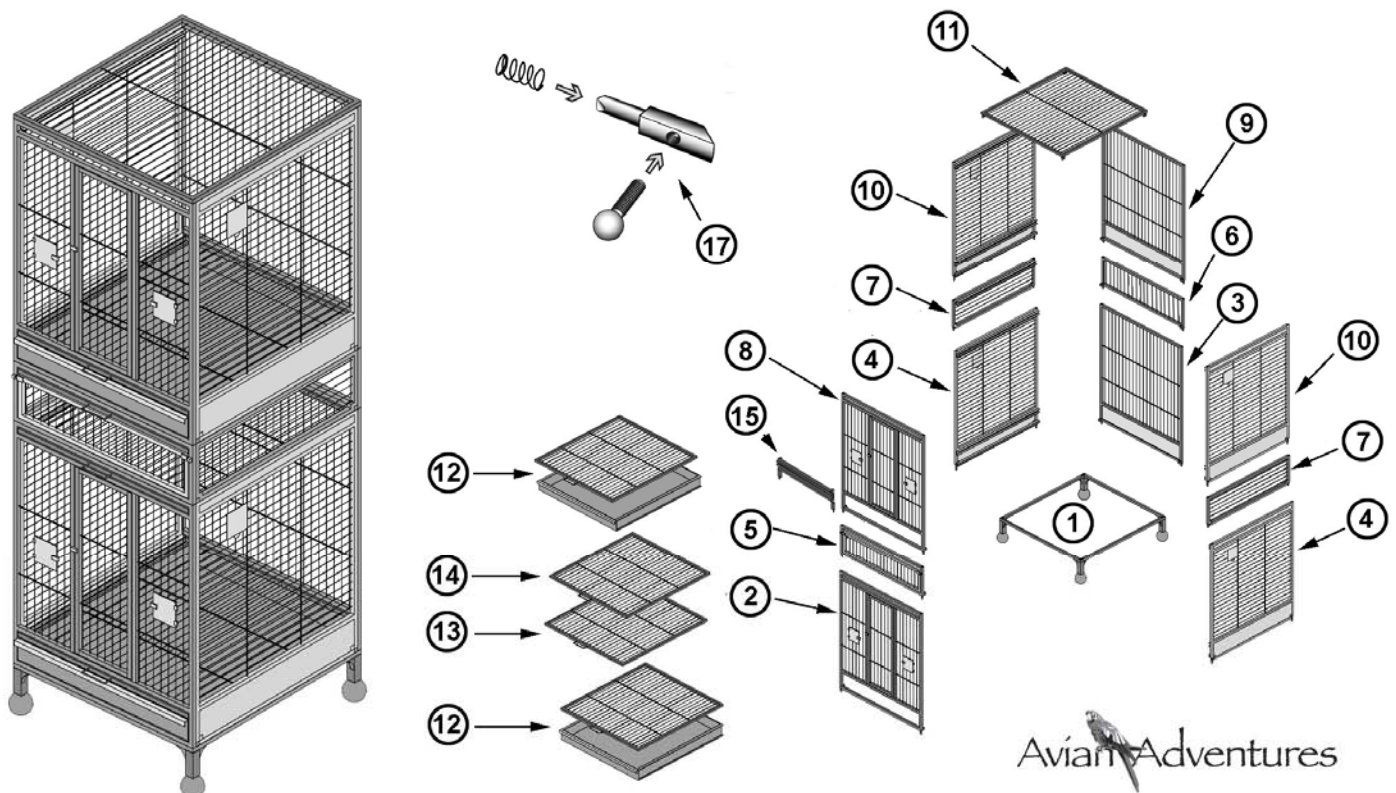

Avian Adventures

Please see our web site at <http://www.avianadventures.com> for a detailed video demonstration of how to assemble a similar cage.